

NIGHTWATCHER

MOTION TRACKING SENSOR LED LIGHT

INSTALLATION & OPERATING MANUAL



NIGHTWATCHER SURVEILLANCE PRO
MODEL NO: NW1201X

TABLE OF CONTENTS

1. Contents of package
2. Nightwatcher Surveillance Pro L.E.D
3. Installation
4. Programming your Surveillance Pro
5. Set the date and time of Surveillance Pro
6. Viewing video
7. Technical Specifications
8. General Information and Safety

CONTENTS OF PACKAGING

- Nightwatcher Surveillance Pro
- User Manual
- 1 Allen key
- Accessory bag: 2pcs screws, 2pcs plastic masonry plugs
- Micro SD and SD adaptor

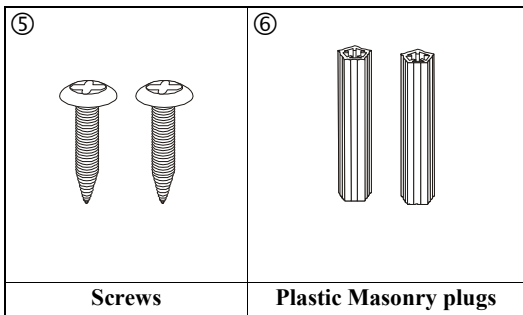
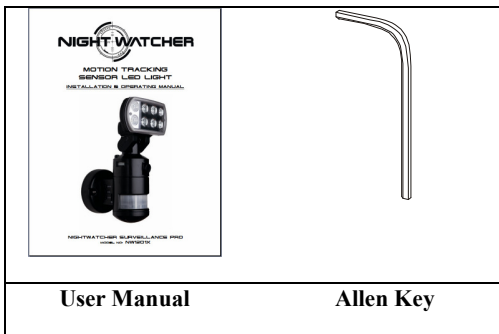
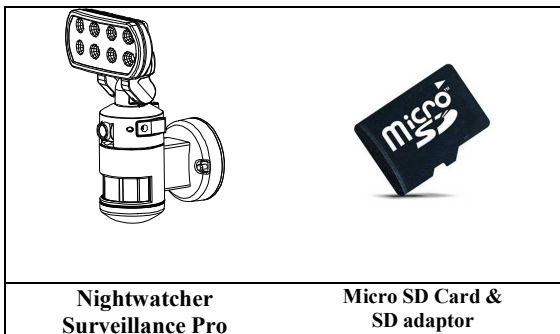

INTRODUCTION

Congratulations on the purchase of your new Nightwatcher Security Light. Before installation of the unit, please read the operating instructions and safeguards carefully. It is important that you read and follow the instructions in the manual, even if you feel you are familiar with this type of product.

Please retain the instructions in a safe place for future reference

SPECIFICATIONS

Model Number:	NW1200x
AC Input:	220-240V 50Hz
Time Adjustment:	Fixed at 3 Minutes
Sensor Range:	10m x 210°
Power Consumption:	8 Watts
IP Weather Rating:	IP55
Light Source:	8 x 1Watt Nichia High Power L.E.D
Camera (Video):	20 seconds image recording for image stream: 10fps at 480x640 Pixels – AVI format
Camera (Photo)	640 x 480 – JPEG format
Camera Viewing	Distance – 8M, Angle – 60 Degree
Motor Life	20,000 revolutions

IMPORTANT SAFEGUARDS

WHEN USING ELECTRICAL APPLIANCES, IN ORDER TO REDUCE THE RISK OF FIRE, ELECTRIC SHOCK, AND/OR INJURY, THESE BASIC SAFETY PRECAUTIONS SHOULD ALWAYS BE FOLLOWED:

GENERAL INFORMATION AND SAFETY

Read all instructions carefully, even if you feel you are quite familiar with the appliance.

- Any alterations or additions to building wiring, must be completed by a licensed electrical mechanic, or person authorised by legislation to work on the fixed wiring of any electrical installation
- To prevent electric shock, please ensure that power is disconnected before installing.
- The appliance is not intended for use by children or infirm persons without supervision.
- Children should be supervised to ensure that they do not play with the appliance.
- This unit must be connected to a 220-240V 50Hz power source
- The light must be earthed
- The cable installed shall be 3 x 1.0mm² at least
- The unit is for outdoor use only
- The unit is for wall mounting
- The NW Surveillance Pro is designed to be weather resistant. Never attempt to immerse the unit in water or any other liquid. This will damage the unit and void the warranty.
- This product is designed to illuminate, video, and make verbal announcements. It will not prevent the commission of any act, legal or illegal. The manufacturer assumes no liability for any damage to property, injury to person, or death.

COMPULSORY WARNING

Note: No user serviceable parts inside. Unauthorised modification voids warranty, Return to place of purchase for replacement or service under warranty.

SAVE THESE INSTRUCTIONS

OVERVIEW

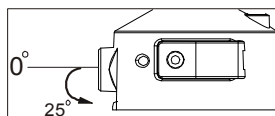
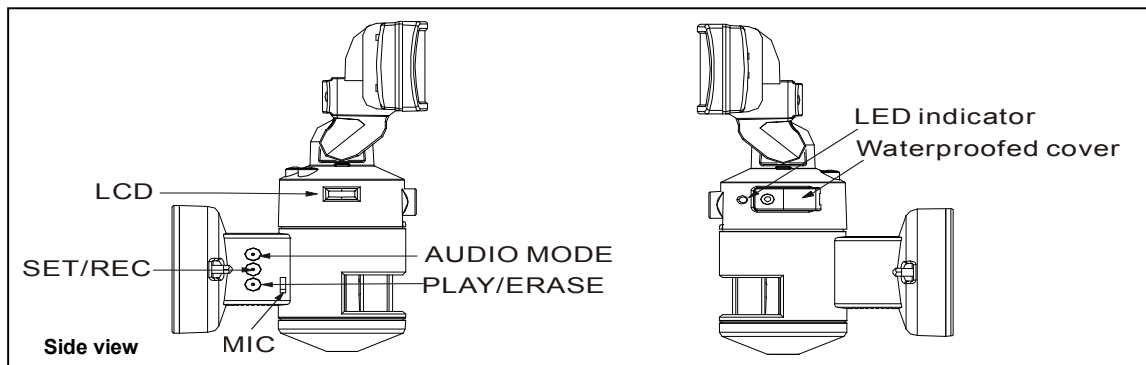
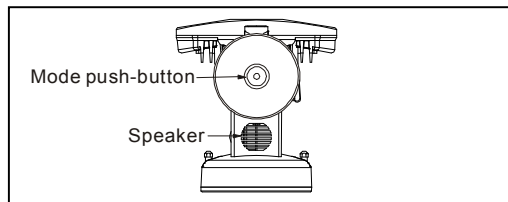
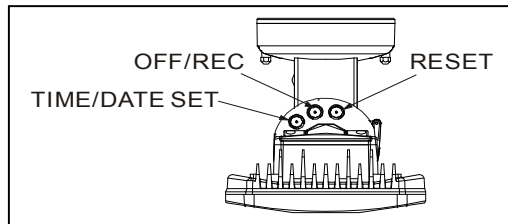
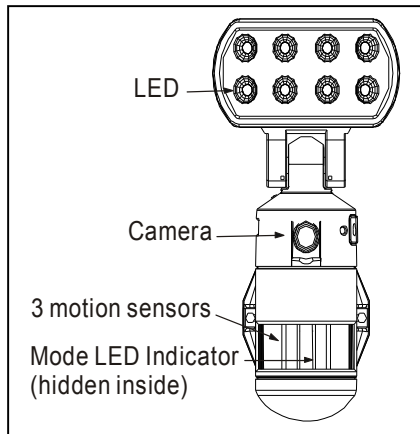

Camera adjustable down 25°

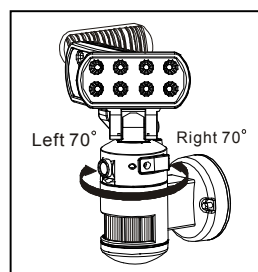

STEP 1. INSERT/REMOVE MICRO SD CARD (SEE FIG. 1):

When the Surveillance Pro is powered, press the push-button on the bottom of the unit for 3 seconds to stop the light turning before attempting to insert or remove the Micro SD card. To resume operation, push the push-button again.

- Unscrew the waterproofed cover using provided Allen key, and then insert the Micro SD card until it automatically locks into place.
- If you need to remove the Micro SD card, please press OFF/REC button and take it out within 30 seconds.
- When LED light turns green, this means the Micro SD card is being read, do not remove SD card or data may be lost.
- To remove Micro SD card, push in Micro SD card to eject then pull out.

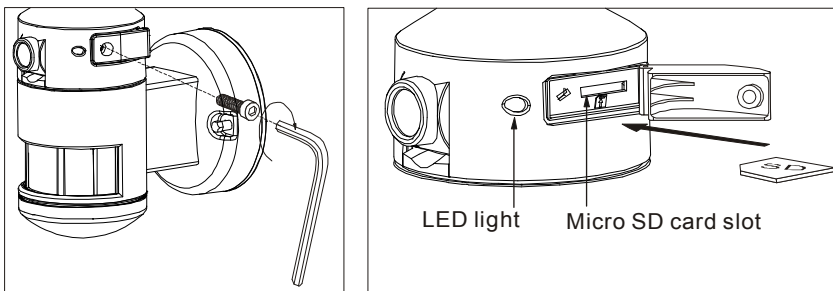

Fig. 1

STEP 2. INSTALLATION

IMPORTANT

IF IN ANY DOUBT ABOUT THE INSTALLATION OF THIS PRODUCT, CONSULT A QUALIFIED ELECTRICIAN

- This product must be grounded
- Do not mount the unit against inflammable surfaces
- The motion detector will not operate correctly if it is installed:
 - ① Near the outlet of a central heating boiler
 - ② Near air conditioning plant
 - ③ Pointing directly at moving vehicles
 - ④ Within sight of reflections from moving water
 - ⑤ Where other lamps could shine on the detector

*BEFORE ATTEMPTING ANY INSTALLATION OR MAINTENANCE, ENSURE THAT THE ELECTRICAL SUPPLY IS SWITCHED OFF AND THE CIRCUIT FUSES REMOVED OR THE CIRCUIT BREAKER IS IN THE OFF POSITION.

*Please make sure the voltage and polarity are correct before connection. Incorrect voltage may cause electric shock. If you are not sure, please contact your retailer.

*** DO NOT REMOVE THE TAPE UNTIL YOU FINISH THE INSTALLATION. IF THE TAPE COMES OFF THE LIGHT, PLEASE REPLAE IT OR HOLD THE LIGHT HEAD TO AVOID SWIVELING AND DAMAGE THE PRODUCT.**

*Note: It is recommend to mount Smart Tracker 2M above the ground for optimum performance, do not mount the fixture below 1.2M. See below figure for details of performance range.

TOP VIEW



Fig. 2

GOOD SENSITIVITY

LESS SENSITIVITY

Detection range: 10M x 210° (see fig. 3)



Fig. 3

INSTALLING YOUR UNIT ONTO A SURFACE. (See fig. 4 & fig. 5)

1. Place plastic masonry plugs into desired surface aligning holes as shown below. Using an electric screwdriver, fasten mounting plate directly to surface using screws E.
2. Feed the cable through the back mounting box and bush the cable entry to avoid abrasion to the cable.
3. Wire the unit as follows: (Ensure all wires are connected securely and that no loose strands are exposed)

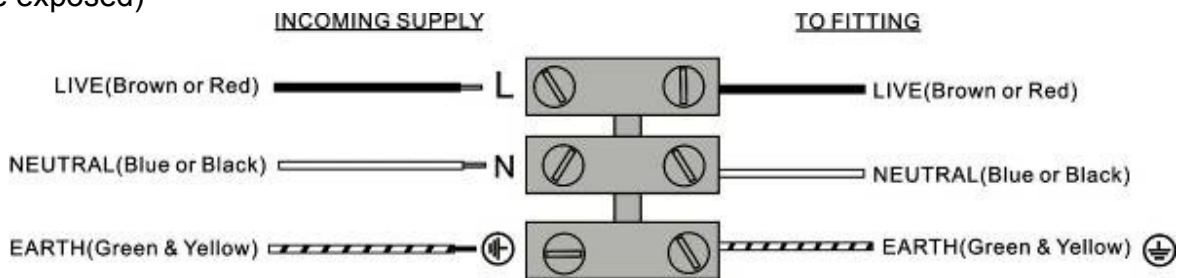

4. Make sure the polarity is correct. Double check the connections after wiring. Mis-wiring may damage the motion sensor or cause a fire hazard.
5. Place plastic masonry plugs into desired surface aligning holes as shown below. Using an electric screwdriver, fasten mounting plate directly to surface using screws

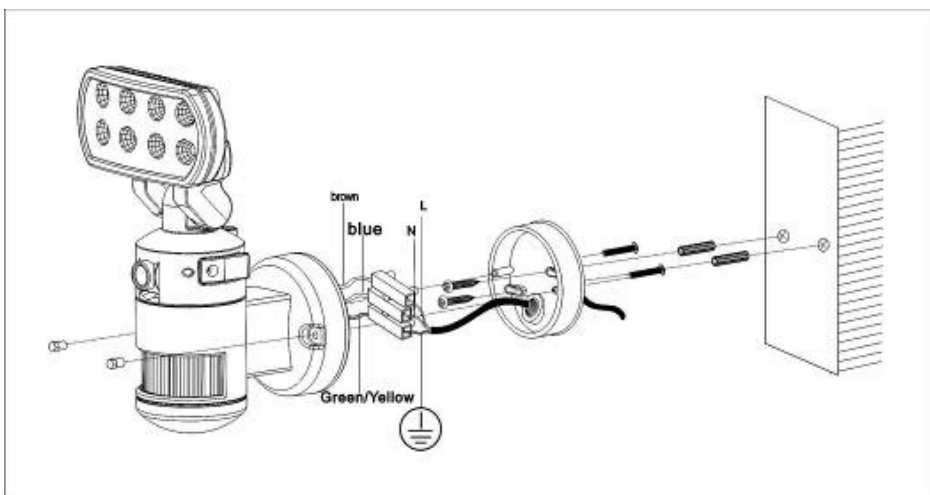

Fig. 4

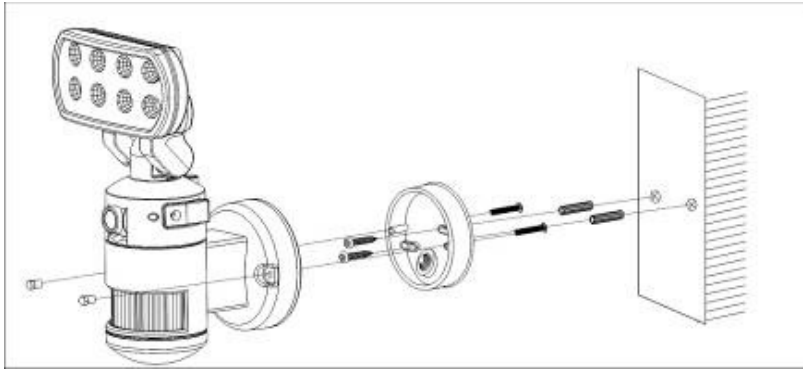

Fig. 5

Please allow 1 minute warm-up time after switching on.
 * Push the RESET button after switching on.

Remove plastic lens cover from camera and the tape after installation. (See fig. 6)

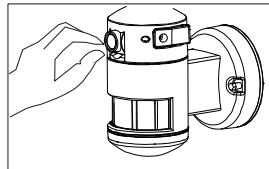

Fig. 6

STEP 3. ADJUSTING THE SETTINGS

(see fig. 7~10)

- **Selecting working mode:** Mode LED Indicator hidden inside the lens will display different LED lights when switching different modes. LED light will turn off after 30 seconds.

Mode 1: Perfect for a place of business (default setting)

- Light at night + camera all day + speaker at night
- Daytime: light is off, camera is on, speaker is off
- Nighttime: light is on, camera is on, speaker is on

Mode 2: Suggested setting when out of town

- Light + camera + speaker: all day detection
- Daytime and nighttime: light, camera and speaker are all in operation

Mode 3: Suggested for day to day use

- Light at night + camera all day + speaker in the daytime
- Daytime: light is off, camera is on, speaker is on
- Nighttime: light is on, camera is on, speaker is off

* For above 3 modes, after audio is triggered, no audio will be triggered in the following 30 seconds.

	Mode LED Indicator (hidden inside the lens)	Symbol
Mode 1	RED	Ⓜ Ⓛ Ⓜ
Mode 2	ORANGE	Ⓜ Ⓛ Ⓜ
Mode 3	GREEN	Ⓜ Ⓛ Ⓜ

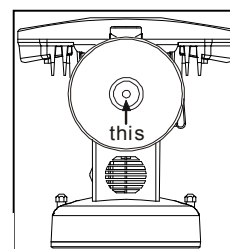

Fig. 7

- **Camera LED** for indicating the function status of the unit by different color LED lights.
 - 1) Red : Micro SD card (part no.②) is not inserted into the Micro SD slot or the system is malfunctioning.
 - 2) Green : The unit is recording.
 - 3) LED off: stand by Micro SD card is inserted into the slot) , when OFF/REC button is pressed.

* Before removing Micro SD card from the slot, please press the push-button on the bottom of the Smart Tracker for 3 seconds to stop the light turning. To resume to work, push the push-button again.

* Please note when OFF/REC button is pressed, remove Micro SD card (part no.②) within 30 seconds (now the LED will turn red after Micro SD card is removed from the slot)

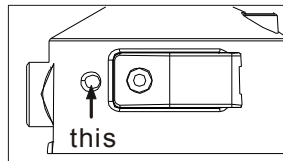

Fig. 8

- **Reset button** : restore functions to default settings
 - 1) Press RESET button once each time you turn on unit.
 - 2) Please press this button in case of system malfunction.
- **Off/Rec** : Please press OFF/REC button to remove Micro SD card. Please remove card within 30 seconds of pressing the OFF/REC button to avoid loss of data.
- **Audio mode:** for selecting which audio message will play when motion sensor detects movement.
 - Pre-set default is "silent mode"
 - Push one time for "doorbell chime"
 - Push again for "dog barking"
 - Push one more time for the message you recorded (Message 1)
 - Push again for additional message you recorded (Message 2 - you can record up to 2 messages at a time)

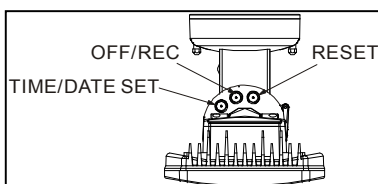

Fig. 9

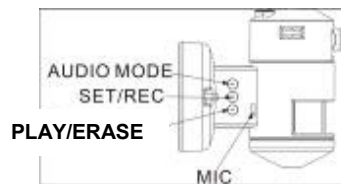

Fig. 10

STEP 4. RECORDING AUDIO MESSAGES (SEE FIG. 10)

1. Press the SET/REC button for 3 seconds, and you will hear a single beep. After the beep, start recording your message by talking into the microphone (see fig. 10). Push the button again to stop recording, and you will hear a series of 2 beeps, meaning the recording is finished. If you do not push the button again after you have recorded the message, the recording will stop automatically after 10 seconds.
2. Smart Tracker can hold 2 self-recorded messages. If you have recorded one message, repeat above step for message 2.
 2. If you hear a series of 3 beeps when you want to record your message by pressing the SET/REC button for 3 seconds, this means the self-recorded messages are full, please erase previous messages.

- **Play/Erase** : allows you to listen to and erase messages (see fig. 10)
 - i. If you have only recorded 1 message, push the button one time to listen to recorded Message 1. If you wish to erase it, press the PLAY/ERASE button and hold it for 3 seconds. You will hear a series of 2 beeps, indicating the message has been erased.
 - ii. If you have recorded 2 messages, push the button one time to listen to the first message, and push it again to listen to the second message. If you want to erase a message, select that message, and after listening to it, push the PLAY/ERASE button and hold it for 3 seconds to erase it.
 - iii. If message 1 is erased, message 2 will automatically become message 1. The next message you record will then become the new message 2.

STEP 5. SET THE DATA AND TIME :

This will allow the security video taken by NW Surveillance Pro to display the correct date and time it was taken.

1. Push TIME/DATE SET button (see fig. 11) for 3 seconds, LCD screen will flash 3 times indicating you have entered Time/Date setting mode.

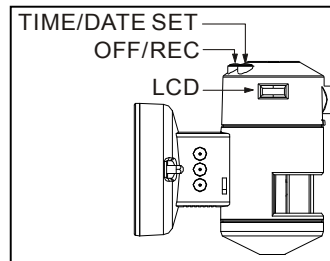



Fig. 11

1. **“YEAR” setting** : “Y” and “08” displayed on the screen ; push the button to set year from “08-99”, push the button again and hold for 3 seconds to scroll through numbers quickly. If you have not pressed the button for 3 seconds, it will automatically save the year and go on to allow you to set the month.

2. Repeat the same setting procedure for **MONTH/DATE/HOUR/MINUTE**.

1. **“VIDEO/PHOTO” setting** : when entering this mode, these two icons   and “V” appear on the screen push the button to choose “V” (Video) or “P” (Photo) . If you have not pushed any buttons for 3 second, “OK” will appear on the screen, indicating it has automatically saved the current settings. The LCD screen will shut off automatically 10 seconds later.

* On the “P” (photo) setting, Smart Tracker will take a series of digital photographs at a rate of 3 photos every second when the motion sensor is triggered

①		Start	②		YEAR Setting
③		MONTH Setting	④		DATE Setting
⑤		HOUR Setting	⑥		MINUTE Setting
⑦		VIDEO/PHOTO Setting	⑧		Finish

STEP 6. VIEWING VIDEO

1. Viewing image by computer through a card reader (see fig. 12)

- Open the waterproofed cover on the NW Surveillance Pro.
- Press OFF/REC button and remove Micro SD card from the slot.
- Put the Micro SD card into adapter then insert this adapter into card reader. Connect PC and card reader by USB cable (not included) and open any media player to view the video.

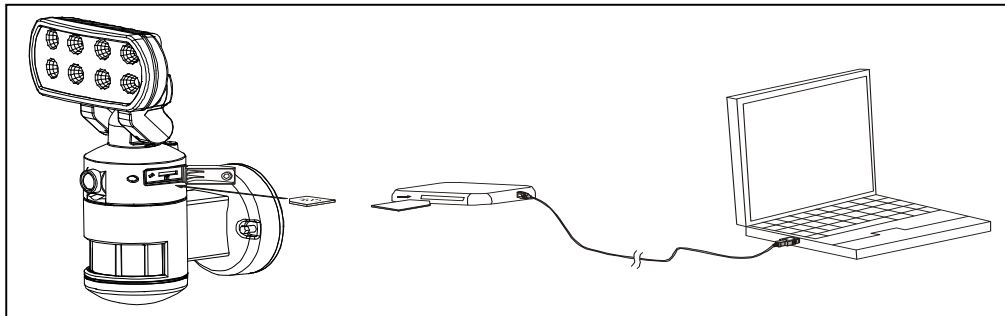

Fig. 12

SPECIAL CARE INSTRUCTIONS

- The NW Surveillance Pro is designed to be weather resistant. Never attempt to immerse the unit in water or any other liquid. This will damage the unit and void the warranty.
- This product is designed to illuminate, video, and make verbal announcements. It will not prevent the commission of any act, legal or illegal. The manufacturer assumes no liability for any damage to property, injury to person, or death.
- Use a soft lens cloth for cleaning lens. Avoid touching lens with fingers.
- Remove dirt or stains with a soft cloth dampened with water or neutral detergent. Keep the NW Surveillance Pro in a dry and cool dust-free environment or container when it is NOT used
- Do not open the NW Surveillance Pro for unauthorized service. This could cause serious damage to the unit and will void the warranty.
- This NW Surveillance Pro is a precision electronic device. Do not attempt to service this camera yourself, as opening or removing covers may expose you to the danger of electric shock or other risks.

FAQ (FREQUENTLY ASKED QUESTIONS) SECTION

Q. How many pictures does the SD card hold?

A: The size in bytes of each 20-second video clip will vary depending on the amount of brightness, color, and movement in each video clip. The clips typically vary from 2MB to 8MB.

SD Card	File Size	Qty of File(approx.)
1G	2Mb	500
1G	8Mb	125
2G	2Mb	1000
2G	8Mb	250

Q. What happens when the card is full?

A: Smart Tracker will automatically return to the oldest file and save over it each time a new video clip is stored. That means you don't have to take out the SD card unless you wish to review or save the video files.

Q. Can I transfer pictures from the camera via cable?

A: No, you can't. If your computer has an SD card slot, you may insert the SD card directly into the computer and access the files by going to My Computer and opening the removable for the SD card, which should appear when you insert the card. See Step 6 "Viewing video" in your instruction manual for details. If you don't have an SD card slot, you may purchase an SD card reader from any retailer that sells electronics. Once you have an SD card reader, simply insert the card into the reader and attach the reader to your computer using a USB slot (not included in this packaging), and access the data the same way as explained above.

Q. Can I view a live image of what the camera sees?

A: No, you can't. There is no USB port available with NW Surveillance Pro

PRODUCT WARRANTY

1 YEAR REPLACEMENT WARRANTY

Your Nightwatcher Security Light is covered for a Period of 12 months from your **Date of Purchase.**

The Warranty covers faulty parts or workmanship.

The warranty is only made available by returning the product to your point of purchase with your receipt.

PURCHASED FROM:

DATE OF PURCHASE:

PRODUCT SERIAL #:

THIS WARRANTY FORM SHOULD BE RETAINED BY THE CUSTOMER AT ALL TIMES.

WARNING

The following actions will result in the warranty being void:

- If the product has been operated on a supply voltage other than that specified on the unit
- If the product shows signs of damage or defects caused by or resulting from abuse.
- If the product has been disassembled or tampered with in any way.
- If the product is not drilled, mounted and used in accordance with the instructions.

Note: Warranty excludes consumable parts such as tubes, globes and batteries.

YOUR WARRANTY FORM SHOULD BE RETAINED BY YOU AT ALL TIMES. SHOULD YOU HAVE ANY QUESTIONS PRIOR TO RETURNING YOUR PRODUCT FOR WARRANTY OR REPAIR PLEASE TELEPHONE OUR CUSTOMER SERVICE HELPLINE:

CUSTOMER SERVICE: 1300 281 005

TO ENSURE A QUICK RESPONSE PLEASE HAVE THE MODEL NUMBER, SERIAL NUMBER AND DATE OF PURCHASE AVAILABLE. A CUSTOMER SERVICE REPRESENTATIVE WILL TAKE YOUR CALL AND ANSWER ANY QUESTIONS YOU MAY HAVE RELATING TO THE WARRANTY POLICY OR PROCEDURE.

newlite

NEWLITE PTY LTD

E6, 2A Westall Road, Clayton,
Victoria, Australia, 3168

Phone: 1300 281 005

Fax: 03 8610 0393

Email: info@newlitecorp.com.au

Web: www.newlitecorp.com.au